

Protectorshell-SP (Single Part)

Traditional clip-together Protectorshell convenience in a single-part design to minimize inventory and simplify underwater laying in poor visibility, etc. The clean, robust design you have come to expect from Protectorshell with added convenience and simplicity.

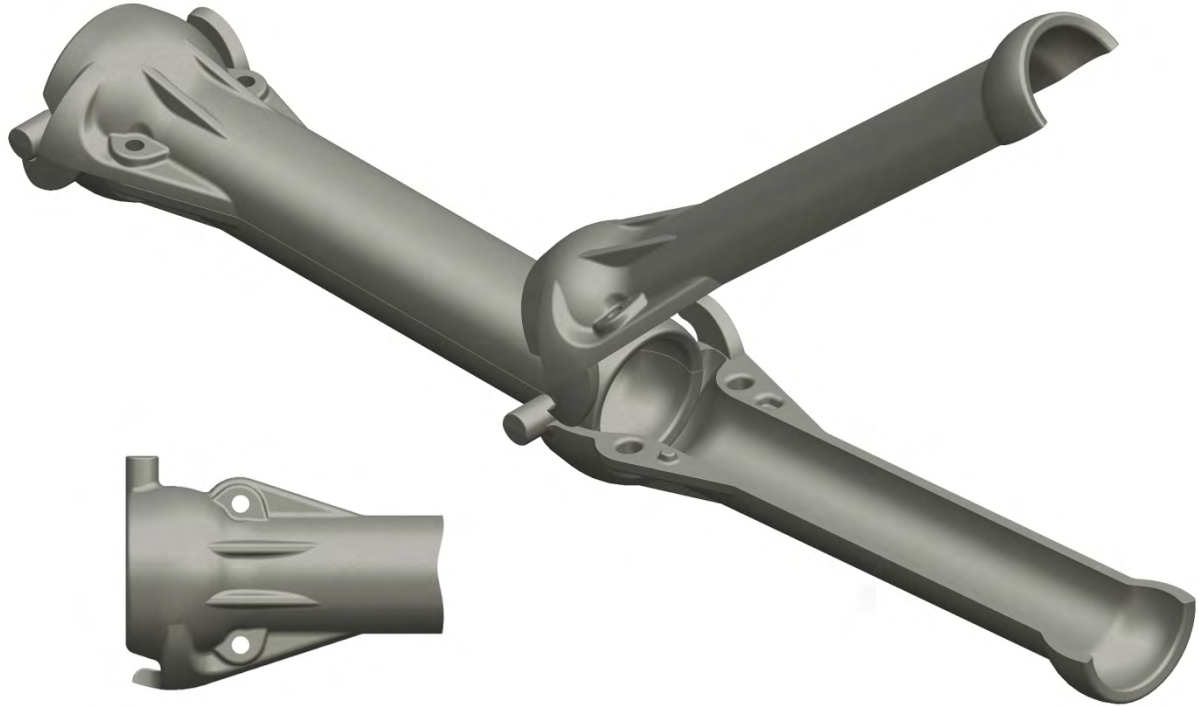

PS140-SP/500/10

Specifications

Segment Length - Overall	562mm
Effective Installed Length/segment pair	500mm
Minimum Internal Diameter	Ø.140mm - for cables up to Ø.127mm diameter
Maximum External Diameter	Ø.266mm (widest points)
Wall Thickness	10mm
Material	Ductile Iron to ISO 1083
Tensile Strength / Elongation	400MPa / 15% elongation
Impact Resistance	12m Drop test or 26kg
Minimum Bend Diameter	Ø4.0m
Weight per Segment	23.4kg
Weight per installed metre (air)	46.8kg
Weight per installed metre (water)	40.4kg

Fasteners M12x40 Bolt and M12 Nyloc Nut – Material: Stainless Steel G316/A4
Recommended usage: 1 pair per 10 metres of installed pipe

Protectorshell SL

C Regata Cutty Sark No 21 4 IZ 15002 La Coruña, Spain
T: +34 8 8124 1115 F: +34 8 8192 4978

www.protectorshell.com

MS Diversified Services Pty Limited

PO Box 150 Maroubra NSW 2035 Australia
1135 Anzac Parade, Matraville, NSW 2036 Australia
T: +61 2 9694 1004 F: +61 2 9314 3526